

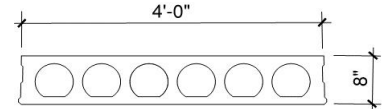

EX-120 Load Table

8" Thick

1.0" Strand Cover



No Structural Topping					
Dead Load Weight of Slab = 62.8 psf					
IBC Fire Ratings	Unrestrained 1 hours				
	Restrained 1 1/2 hours*				
Section Properties					
A = 218 in ²		Yt = 3.92 in		b = 11.19 in	
I = 1697 in ⁴		Yb = 4.08 in		wt = 62.8 psf	
φM _n ft-k/ft	19.71	26.19	36.85		
Series	1.0CA-8607	1.0CA-8707	1.0CA-8807		
Span in Feet	Allowable Superimposed Load In lbs/ft ²				
12	542	547			
13	494	499			
14	436	458			
15	387	423	412		
16	338	383	382		
17	294	345	356		
18	257	312	333		
19	226	282	312		
20	199	258	294		
21	176	237	272		
22	156	217	249		
23	139	200	230		
24	124	180	212		
25	110	162	201		
26	99	146	189		
27	88	132	175		
28	78	120	162		
29	70	108	150		
30		98	140		
31		89	133		
32		81	124		
33		73	117		
34			111		
35			103		
36			95		
37			87		
38			80		
38			80		

2" Bonded Structural Topping					
Dead Load Weight of Slab With Topping = 87.8 psf					
IBC Fire Ratings	Unrestrained 1 hours				
	Restrained 3 hours*				
Section Properties					
A = 278.5 in ²		Yt = 4.88 in		b = 11.19 in	
I = 2826 in ⁴		Yb = 5.12 in		wt = 87.8 psf	
φM _n ft-k/ft	24.85	32.65	45.05		
Series	1.0CA-8607T	1.0CA-8707T	1.0CA-8807T		
Span in Feet	Allowable Superimposed Load In lbs/ft ²				
12	595	593			
13	544	542			
14	500	498			
15	463	461	459		
16	419	428	426		
17	364	399	397		
18	317	373	371		
19	278	350	348		
20	245	324	328		
21	216	297	309		
22	191	271	292		
23	169	243	276		
24	150	217	262		
25		195	249		
26		176	234		
27		158	215		
28		142	198		
29			184		
30			173		
31			160		
32			147		

Concrete Strength: 9,000 psi at 28 days
 Prestress Strands: 3/8", 7/16", 1/2" special, 270 ksi Lo-Lax
 Strands Stressed to 61%

*Limited by heat transmission requirements of ASTM E-119

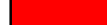
 Camber 1"-1 1/2"
 Camber > 1 1/2"

Issued: 3/11/2019
 ©Spancrete www.spancrete.com



EX-120 Load Table

8" Thick

1.63" Strand Cover

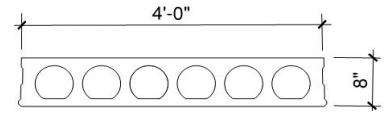

No Structural Topping					
Dead Load Weight of Slab = 62.8 psf					
IBC Fire Ratings	Unrestrained 1 1/2 hours*				
	Restrained 1 1/2 hours*				
Section Properties					
A = 218 in ²		Yt = 3.92 in		b = 11.19 in	
I = 1697 in ⁴		Yb = 4.08 in		wt = 62.8 psf	
ϕM_n ft-k/ft	17.82	23.62	33.11		
Series	1.63CA-8607	1.63CA-8707	1.63CA-8807		
Span in Feet	Allowable Superimposed Load In lbs/ft ²				
12	508	515			
13	460	470			
14	403	431			
15	349	397	390		
16	301	353	362		
17	261	317	337		
18	228	287	315		
19	199	261	295		
20	175	237	273		
21	155	217	250		
22	137	197	231		
23	121	176	211		
24	107	158	196		
25	95	142	183		
26	84	127	172		
27		115	159		
28		103	147		
29		93	136		
30			129		
31			120		
32			113		
33			105		
34			96		

2" Bonded Structural Topping					
Dead Load Weight of Slab With Topping = 87.8 psf					
IBC Fire Ratings	Unrestrained 2 hours				
	Restrained 3 hours*				
Section Properties					
A = 278.5 in ²		Yt = 4.88 in		b = 11.19 in	
I = 2826 in ⁴		Yb = 5.12 in		wt = 87.8 psf	
ϕM_n ft-k/ft	22.95	30.09	41.31		
Series	1.63CA-8607T	1.63CA-8707T	1.63CA-8807T		
Span in Feet	Allowable Superimposed Load In lbs/ft ²				
12	548	545			
13	500	498			
14	460	458			
15	425	423	421		
16	382	392	391		
17	331	365	364		
18	288	342	340		
19	252	320	319		
20	221	296	299		
21	194	268	282		
22	171	245	266		
23		218	252		
24		195	238		
25			224		
26			209		
27			192		
28			176		
29			166		

Concrete Strength: 9,000 psi at 28 days
 Prestress Strands: 3/8", 7/16", 1/2" special, 270 ksi Lo-Lax
 Strands Stressed to 61%

Camber 1"-1 1/2"
 Camber > 1 1/2"

Issued: 3/11/2019
 ©Spancrete www.spancrete.com

*Limited by heat transmission requirements of ASTM E-119



EX-120 Load Table 8" Thick 2.13" Strand Cover

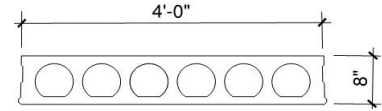

No Structural Topping Dead Load Weight of Slab = 62.8 psf					
IBC Fire Ratings	Unrestrained 1 1/2 hours*				
	Restrained 1 1/2 hours*				
Section Properties					
A = 218 in ²	Yt = 3.92 in		b = 11.19 in		
I = 1697 in ⁴	Yb = 4.08 in		wt = 62.8 psf		
φM _n ft-k/ft	16.31	21.58	30.13		
Series	2.13CA-8607	2.13CA-8707	2.13CA-8807		
Span in Feet	Allowable Superimposed Load In lbs/ft ²				
12	505				
13	435	471			
14	369	427	427		
15	315	377	391		
16	271	336	363		
17	235	302	338		
18	204	274	315		
19	179	250	286		
20	157	222	259		
21	138	197	237		
22	121	176	219		
23		157	200		
24		140	186		
25		125	172		
26		112	160		
27			149		
28			139		
29			130		
30			120		

2" Bonded Structural Topping Dead Load Weight of Slab With Topping = 87.8 psf					
IBC Fire Ratings	Unrestrained 3 hours				
	Restrained 3 hours*				
Section Properties					
A = 278.5 in ²	Yt = 4.88 in		b = 11.19 in		
I = 2826 in ⁴	Yb = 5.12 in		wt = 87.8 psf		
φM _n ft-k/ft	21.44	28.05	38.34		
Series	2.13CA-8607T	2.13CA-8707T	2.13CA-8807T		
Span in Feet	Allowable Superimposed Load In lbs/ft ²				
12	534				
13	488	488			
14	448	448			
15	410	414			
16	353	384	384		
17	305	357	357		
18	265	334	334		
19	231	308	313		
20	202	277	294		
21		252	277		
22		224	261		
23			243		
24			225		
25			208		
26			191		

Concrete Strength: 9,000 psi at 28 days
 Prestress Strands: 3/8", 7/16", 1/2" special, 270 ksi Lo-Lax
 Strands Stressed to 61%
 *Limited by heat transmission requirements of ASTM E-119

	Camber 1"-1 1/2"	Issued: 3/11/2019
	Camber > 1 1/2"	©Spancrete www.spancrete.com

Load tables are presented as guidelines only. Design requirements must be reviewed by the engineer of record for each specific project.



EX-120 Load Table

8" Thick

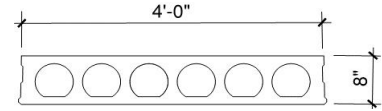

2.25" Strand Cover



No Structural Topping					
Dead Load Weight of Slab = 62.8 psf					
IBC Fire Ratings	Unrestrained 1 1/2 hours*				
	Restrained 1 1/2 hours*				
Section Properties					
A = 218 in ²	Yt = 3.92 in		b = 11.19 in		
I = 1697 in ⁴	Yb = 4.08 in		wt = 62.8 psf		
φM _n ft-k/ft	15.95	21.09	29.42		
Series	2.25CA-8607	2.25CA-8707	2.25CA-8807		
Span in Feet	Allowable Superimposed Load In lbs/ft ²				
12	500	517			
13	425	471	462		
14	360	424	424		
15	308	375	391		
16	265	335	363		
17	229	300	338		
18	199	269	310		
19	174	245	281		
20	152	216	257		
21	134	192	233		
22		171	215		
23		152	199		
24		136	182		
25			170		
26			157		
27			148		
28			136		
29			128		

2" Bonded Structural Topping					
Dead Load Weight of Slab With Topping = 87.8 psf					
IBC Fire Ratings	Unrestrained 3 hours				
	Restrained 3 hours*				
Section Properties					
A = 278.5 in ²	Yt = 4.88 in		b = 11.19 in		
I = 2826 in ⁴	Yb = 5.12 in		wt = 87.8 psf		
φM _n ft-k/ft	21.08	27.56	38.34		
Series	2.25CA-8607T	2.25CA-8707T	2.25CA-8807T		
Span in Feet	Allowable Superimposed Load In lbs/ft ²				
12	534	534			
13	488	488	488		
14	448	448	448		
15	402	414	414		
16	346	384	384		
17	299	357	357		
18	259	334	334		
19		303	313		
20		277	294		
21		246	277		
22			261		
23			243		
24			221		

Concrete Strength: 9,000 psi at 28 days
 Prestress Strands: 3/8", 7/16", 1/2" special, 270 ksi Lo-Lax
 Strands Stressed to 61%
 *Limited by heat transmission requirements of ASTM E-119

 Camber 1"-1 1/2" Issued: 3/11/2019
 Camber > 1 1/2" ©Spancrete www.spancrete.com

Load tables are presented as guidelines only. Design requirements must be reviewed by the engineer of record for each specific project.



EX-120 Load Table

10" Thick

1.0" Strand Cover

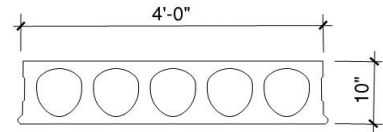



No Structural Topping					
Dead Load Weight of Slab = 72.63 psf					
IBC Fire Ratings	Unrestrained 1 hours				
	Restrained 2 hours*				
Section Properties					
A = 252 in ²	Yt = 5.18 in	b = 11.25 in			
I = 3096 in ⁴	Yb = 4.82 in	wt = 72.63 psf			
φM _n ft-k/ft	29.59	38.97	48.17	55.17	67.63
Series	1.0CA-10706	1.0CA-10708	1.0CA-10710	1.0CA-10808	1.0CA-10810
Span in Feet	Allowable Superimposed Load In lbs/ft ²				
	14	602			
15	556	575			
16	497	534	531		
17	447	497	495		
18	402	452	463		
19	355	408	434		
20	315	373	408		
21	281	344	374	380	
22	251	315	345	360	
23	225	291	316	336	
24	202	272	294	310	
25	182	250	271	288	
26	164	234	254	269	
27	148	213	236	250	
28	134	194	222	236	
29	121	177	201	214	244
30	110	162	181	194	227
31	99	148	162	173	215
32	90	134	148	154	205
33	81	121	134	142	196
34		114	121	131	184
35		104	109	114	173
36		96	101	106	163
37		88	93	98	153
38			85	90	144
39			77	82	136
40			69	74	129
41			61	66	123
42			53	58	118
43			45	50	112
44			37	42	106
45			29	34	99
46			21	26	93
47			13	18	86

2" Bonded Structural Topping					
Dead Load Weight of Slab With Topping = 97.63 psf					
IBC Fire Ratings	Unrestrained 1 hours				
	Restrained 4 hours				
Section Properties					
A = 312.8 in ²	Yt = 6.02 in	b = 11.25 in			
I = 4918 in ⁴	Yb = 5.98 in	wt = 97.63 psf			
φM _n ft-k/ft	35.38	46.13	56.33	64.30	78.19
Series	1.0CA-10706T	1.0CA-10708T	1.0CA-10710T	1.0CA-10808T	1.0CA-10810T
Span in Feet	Allowable Superimposed Load In lbs/ft ²				
	14	620			
15	573	574			
16	533	533	533		
17	497	497	497		
18	465	466	466		
19	416	437	437		
20	369	412	412		
21	328	389	389	387	
22	292	368	368	366	
23	261	349	348	347	
24	234	327	331	330	
25	210	296	315	314	
26	188	268	300	299	
27	169	243	283	285	
28	152	221	266	266	
29		201	241	241	260
30			221	221	249
31			201	201	239
32			181	181	229
33			161	161	220
34			141	141	211
35			121	121	203
36			101	101	191
37			81	81	179
38			61	61	168
39			41	41	158
40			21	21	151
41					139
42					128

NOT USED

NOT USED

Concrete Strength: 9,000 psi at 28 days
 Prestress Strands: 3/8", 7/16", 1/2" special, 270 ksi Lo-Lax
 Strands Stressed to 61%

 Camber 1"-1 1/2"
 Camber > 1 1/2"

Issued: 3/11/2019
 ©Spancrete www.spancrete.com

*Limited by heat transmission requirements of ASTM E-119



EX-120 Load Table

10" Thick

1.63" Strand Cover

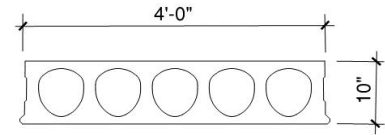

No Structural Topping					
Dead Load Weight of Slab = 72.63 psf					
IBC Fire Ratings	Unrestrained 2 hours				
	Restrained 2 hours*				
Section Properties					
A = 252 in ²	Yt = 5.18 in	b = 11.25 in			
I = 3096 in ⁴	Yb = 4.82 in	wt = 72.63 psf			
ϕM_n ft-k/ft	27.39	35.75	43.91	51.21	63.13
Series	1.63CA-10706	1.63CA-10708	1.63CA-10710	1.63CA-10808	1.63CA-10810
Span in Feet	Allowable Superimposed Load In lbs/ft ²				
14	556				
15	513	532			
16	464	494	511	508	
17	417	453	476	473	492
18	368	409	439	443	460
19	325	372	398	415	432
20	288	337	363	391	407
21	256	309	333	358	384
22	228	286	304	329	354
23	204	262	281	301	327
24	183	243	260	279	300
25	164	227	241	258	279
26	148	210	225	240	258
27	133	191	209	224	241
28	120	173	196	209	224
29	108	158	183	195	210
30		144	172	184	196
31		131	161	171	185
32		120	151	163	176
33			144	152	168
34				144	158
35				136	148
36				128	138
37				122	130
38					123
39					118

2" Bonded Structural Topping					
Dead Load Weight of Slab With Topping = 97.63 psf					
IBC Fire Ratings	Unrestrained 2 hours				
	Restrained 4 hours				
Section Properties					
A = 312.8 in ²	Yt = 6.02 in	b = 11.25 in			
I = 4918 in ⁴	Yb = 5.98 in	wt = 97.63 psf			
ϕM_n ft-k/ft	33.18	41.56	49.36	64.12	81.19
Series	1.63CA-10706T	1.63CA-10708T	1.63CA-10710T	1.63CA-10808T	1.63CA-10810T
Span in Feet	Allowable Superimposed Load In lbs/ft ²				
14	579				
15	536	536			
16	498	498	498	496	
17	464	464	464	462	473
18	434	434	434	433	442
19	386	407	407	406	414
20	341	383	383	382	388
21	303	362	362	360	366
22	269	342	342	341	341
23	240	319	324	323	323
24	215	287	307	306	306
25	192	259	290	291	291
26		234	271	277	277
27		212	251	264	264
28			234	250	252
29			218	235	241
30				218	230
31				206	220
32				191	208
33					198
34					185

Concrete Strength: 9,000 psi at 28 days
 Prestress Strands: 3/8", 7/16", 1/2" special, 270 ksi Lo-Lax
 Strands Stressed to 61%

*Limited by heat transmission requirements of ASTM E-119

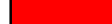
 Camber 1"-1 1/2"
 Camber > 1 1/2"

Issued: 3/11/2019
 ©Spancrete www.spancrete.com



EX-120 Load Table

10" Thick

2.13" Strand Cover

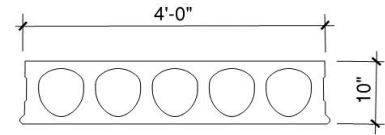



No Structural Topping					
Dead Load Weight of Slab = 72.63 psf					
IBC Fire Ratings	Unrestrained 2 hours*				
	Restrained 2 hours*				
Section Properties					
A = 252 in ²	Yt = 5.18 in	b = 11.25 in			
I = 3096 in ⁴	Yb = 4.82 in	wt = 72.63 psf			
ϕM_n ft-k/ft	25.64	32.42	41.00	47.81	58.90
Series	2.13CA-10706	2.13CA-10708	2.13CA-10710	2.13CA-10808	2.13CA-10810
Span in Feet	Allowable Superimposed Load In lbs/ft ²				
14	545				
15	501	522	541		
16	446	483	502	501	
17	389	433	463	467	486
18	341	390	417	437	455
19	300	353	379	409	427
20	266	322	346	372	401
21	236	297	314	341	366
22	210	270	290	311	336
23	188	251	268	287	308
24	168	233	246	266	285
25	150	213	230	245	265
26	135	192	212	230	244
27	121	175	199	212	229
28	109	158	184	200	212
29			175	185	200
30			162	175	186
31				163	176
32				154	164
33				145	156
34					146
35					137

2" Bonded Structural Topping					
Dead Load Weight of Slab With Topping = 97.63 psf					
IBC Fire Ratings	Unrestrained 3 hours				
	Restrained 4 hours				
Section Properties					
A = 312.8 in ²	Yt = 6.02 in	b = 11.25 in			
I = 4918 in ⁴	Yb = 5.98 in	wt = 97.63 psf			
ϕM_n ft-k/ft	31.43	39.23	46.43	60.73	76.96
Series	2.13CA-10706T	2.13CA-10708T	2.13CA-10710T	2.13CA-10808T	2.13CA-10810T
Span in Feet	Allowable Superimposed Load In lbs/ft ²				
14	547				
15	506	506	523		
16	469	469	483	483	
17	438	438	445	448	467
18	409	409	409	418	436
19	362	384	384	391	408
20	319	361	361	359	383
21	283	340	340	339	348
22	251	321	321	320	320
23	224	297	304	303	303
24	199	267	288	287	287
25		240	271	273	273
26			250	260	260
27				247	247
28				233	236
29					225
30					215

Concrete Strength: 9,000 psi at 28 days
 Prestress Strands: 3/8", 7/16", 1/2" special, 270 ksi Lo-Lax
 Strands Stressed to 61%

*Limited by heat transmission requirements of ASTM E-119

 Camber 1"-1 1/2"
 Camber > 1 1/2"

Issued: 3/11/2019
 ©Spancrete www.spancrete.com



EX-120 Load Table 10" Thick 2.25" Strand Cover

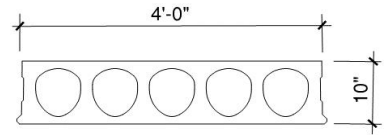

No Structural Topping Dead Load Weight of Slab = 72.63 psf					
IBC Fire Ratings	Unrestrained 2 hours*				
	Restrained 2 hours*				
Section Properties					
A = 252 in ²		Yt = 5.18 in		b = 11.25 in	
I = 3096 in ⁴		Yb = 4.82 in		wt = 72.63 psf	
ϕM_n ft-k/ft	25.22	32.85	40.29	46.99	57.86
Series	2.25CA-10706	2.25CA-10708	2.25CA-10710	2.25CA-10808	2.25CA-10810
Span in Feet	Allowable Superimposed Load In lbs/ft ²				
	14	545			
15	496	523	541		
16	438	477	502	502	
17	382	428	457	467	486
18	335	387	412	437	455
19	295	350	374	403	427
20	261	318	341	367	396
21	231	293	312	336	361
22	206	270	286	309	331
23	184	247	265	283	305
24	164	230	243	263	281
25	147	208	227	242	261
26		188	211	226	241
27		171	196	210	225
28			184	197	210
29				183	196
30				173	184
31				161	173
32				153	161
33					154

2" Bonded Structural Topping Dead Load Weight of Slab With Topping = 97.63 psf					
IBC Fire Ratings	Unrestrained 3 hours				
	Restrained 4 hours				
Section Properties					
A = 312.8 in ²		Yt = 6.02 in		b = 11.25 in	
I = 4918 in ⁴		Yb = 5.98 in		wt = 97.63 psf	
ϕM_n ft-k/ft	31.01	38.66	45.71	59.90	75.94
Series	2.25CA-10706T	2.25CA-10708T	2.25CA-10710T	2.25CA-10808T	2.25CA-10810T
Span in Feet	Allowable Superimposed Load In lbs/ft ²				
	14	544			
15	503	504	523		
16	467	467	484	483	
17	435	435	439	449	468
18	405	407	407	418	436
19	356	381	381	385	409
20	314	359	359	359	378
21	278	338	338	338	343
22	247	318	319	319	319
23	220	292	302	302	302
24		262	287	287	287
25			268	272	272
26				259	259
27				246	247
28				231	235
29					225

Concrete Strength: 9,000 psi at 28 days
 Prestress Strands: 3/8", 7/16", 1/2" special, 270 ksi Lo-Lax
 Strands Stressed to 61%
 *Limited by heat transmission requirements of ASTM E-119

 Camber 1"-1 1/2"
 Camber > 1 1/2"

Issued: 3/11/2019
 ©Spancrete www.spancrete.com

Load tables are presented as guidelines only. Design requirements must be reviewed by the engineer of record for each specific project.



EX-120 Load Table

12" Thick

1.0" Strand Cover

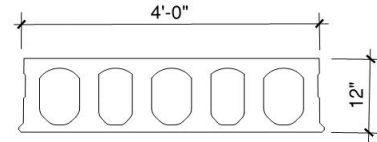

No Structural Topping					
Dead Load Weight of Slab = 90.5 psf					
IBC Fire Ratings	Unrestrained 1 hours				
	Restrained 3 hours*				
Section Properties					
A = 314 in ²	Yt = 5.932 in	b = 17.0 in			
I = 5262 in ⁴	Yb = 6.068 in	wt = 90.5 psf			
ϕM_n ft-k/ft	36.58	48.29	59.75	68.72	84.61
Series	1.0CA-12706	1.0CA-12708	1.0CA-12710	1.0CA-12808	1.0CA-12810
Span in Feet	Allowable Superimposed Load In lbs/ft ²				
18	496				
19	439	601			
20	389	536			
21	347	479	583		
22	310	431	545	569	
23	278	388	497	525	
24	249	351	451	494	
25	225	318	410	457	
26	202	289	374	434	462
27	183	263	342	403	434
28	165	240	313	370	409
29	149	219	287	341	384
30	135	200	264	314	366
31	122	183	243	290	344
32	111	168	224	268	329
33	100	154	206	248	308
34	90	141	190	229	286
35		129	176	212	266
36		118	162	197	247
37		108	150	183	230
38		99	139	170	214
39		91	128	158	200
40			119	147	186
41			110	136	174
42			101	127	162
43			94	118	152
44				109	141
45				102	132
46				94	123
47					115
48					107
49					100
50					93

2" Bonded Structural Topping					
Dead Load Weight of Slab With Topping = 115.5 psf					
IBC Fire Ratings	Unrestrained 1 hours				
	Restrained 4 hours				
Section Properties					
A = 375 in ²	Yt = 6.85 in	b = 17.0 in			
I = 7637 in ⁴	Yb = 7.15 in	wt = 115.5 psf			
ϕM_n ft-k/ft	42.32	55.46	68.02	77.86	95.17
Series	1.0CA-12706T	1.0CA-12708T	1.0CA-12710T	1.0CA-12808T	1.0CA-12810T
Span in Feet	Allowable Superimposed Load In lbs/ft ²				
18	566				
19	499	628			
20	442	571			
21	393	531	565		
22	350	486	527	550	
23	313	437	485	507	
24	281	395	455	477	
25	252	357	423	440	
26	226	323	398	417	444
27	203	294	371	386	415
28	183	267	347	367	392
29	165	243	318	343	365
30	148	221	291	324	349
31		202	267	309	327
32		184	245	289	310
33		168	226	271	295
34		153	207	250	277
35			191	231	265
36			176	214	254
37			162	198	239
38			149	183	228
39				169	218
40				157	201
41				145	186
42					172
43					158
44					146
45					134

Concrete Strength: 9,000 psi at 28 days
 Prestress Strands: 3/8", 7/16", 1/2" special, 270 ksi Lo-Lax
 Strands Stressed to 61%

*Limited by heat transmission requirements of ASTM E-119

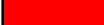
 Camber 1"-1 1/2"
 Camber > 1 1/2"

Issued: 3/11/2019
 ©Spancrete www.spancrete.com



EX-120 Load Table

12" Thick

1.63" Strand Cover

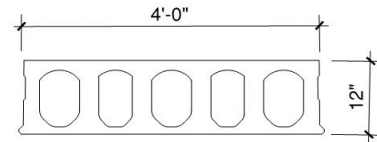

No Structural Topping					
Dead Load Weight of Slab = 90.5 psf					
IBC Fire Ratings	Unrestrained 2 hours				
	Restrained 3 hours*				
Section Properties					
A = 314 in ²	Yt = 5.932 in	b = 17.0 in			
I = 5262 in ⁴	Yb = 6.068 in	wt = 90.5 psf			
ϕM_n ft-k/ft	34.38	45.35	56.16	64.46	79.26
Series	1.63CA-12706	1.63CA-12708	1.63CA-12710	1.63CA-12808	1.63CA-12810
Span in Feet	Allowable Superimposed Load In lbs/ft ²				
15	696				
16	603				
17	527	717			
18	462	632			
19	408	560	653		
20	362	499	594		
21	322	446	551	579	
22	287	400	512	531	
23	257	361	463	496	533
24	230	326	419	463	500
25	207	295	381	431	462
26	186	267	347	407	437
27	168	243	317	374	406
28	151	221	290	343	386
29	136	202	266	315	360
30	123	184	244	290	343
31	111	168	224	267	324
32		153	206	247	305
33		140	190	228	293
34		128	175	211	272
35		117	161	195	252
36		107	149	181	234
37			137	167	218
38			126	155	202
39			117	144	188
40			107	133	175
41				124	163
42				115	152
43				106	141
44					132
45					122
46					114
47					106

2" Bonded Structural Topping					
Dead Load Weight of Slab With Topping = 115.5 psf					
IBC Fire Ratings	Unrestrained 2 hours				
	Restrained 4 hours				
Section Properties					
A = 375 in ²	Yt = 6.85 in	b = 17.0 in			
I = 7637 in ⁴	Yb = 7.15 in	wt = 115.5 psf			
ϕM_n ft-k/ft	40.12	52.53	64.35	73.60	89.83
Series	1.63CA-12706T	1.63CA-12708T	1.63CA-12710T	1.63CA-12808T	1.63CA-12810T
Span in Feet	Allowable Superimposed Load In lbs/ft ²				
15	795				
16	697				
17	607	709			
18	532	647			
19	469	586	634		
20	415	538	576		
21	368	501	533	561	
22	328	456	495	513	
23	292	410	455	478	516
24	261	369	428	444	482
25	234	333	394	414	445
26	210	302	374	388	419
27	188	273	346	363	388
28	169	248	324	340	369
29	152	226	296	322	343
30		205	271	300	324
31		187	248	287	306
32		170	227	269	287
33			209	251	275
34			192	232	259
35			176	214	244
36			162	197	235
37				182	222
38				168	209
39					202
40					187
41					172
42					158

Concrete Strength: 9,000 psi at 28 days
 Prestress Strands: 3/8", 7/16", 1/2" special, 270 ksi Lo-Lax
 Strands Stressed to 61%

*Limited by heat transmission requirements of ASTM E-119

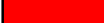
 Camber 1"-1 1/2"
 Camber > 1 1/2"

Issued: 3/11/2019
 ©Spancrete www.spancrete.com



EX-120 Load Table

12" Thick

2.13" Strand Cover

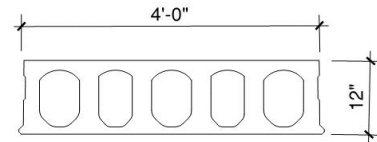



No Structural Topping					
Dead Load Weight of Slab = 90.5 psf					
IBC Fire Ratings	Unrestrained 3 hours				
	Restrained 3 hours*				
Section Properties					
A = 314 in ²		Yt = 5.932 in		b = 17.0 in	
I = 5262 in ⁴		Yb = 6.068 in		wt = 90.5 psf	
ϕM_n ft-k/ft	32.63	43.02	56.16	64.46	75.02
Series	2.13CA-12706	2.13CA-12708	2.13CA-12710	2.13CA-12808	2.13CA-12810
Span in Feet	Allowable Superimposed Load In lbs/ft ²				
15	657				
16	569				
17	496	676			
18	435	596			
19	384	528	618		
20	340	470	565		
21	302	420	524	550	
22	269	376	482	504	545
23	240	339	435	472	508
24	215	305	394	437	473
25	193	276	358	410	440
26	173	250	326	383	414
27	156	227	297	351	385
28	140	206	272	321	365
29	126	188	248	295	342
30	113	171	228	271	323
31		156	209	250	306
32		142	192	230	287
33		129	176	212	276
34		118	162	196	257
35			149	181	238
36			137	168	221
37			126	155	206
38			116	143	192
39				133	178
40				123	166
41					154
42					143
43					133
44					123

2" Bonded Structural Topping					
Dead Load Weight of Slab With Topping = 115.5 psf					
IBC Fire Ratings	Unrestrained 3 hours				
	Restrained 4 hours				
Section Properties					
A = 375 in ²		Yt = 6.85 in		b = 17.0 in	
I = 7637 in ⁴		Yb = 7.15 in		wt = 115.5 psf	
ϕM_n ft-k/ft	38.37	50.20	61.44	70.22	85.59
Series	2.13CA-12706T	2.13CA-12708T	2.13CA-12710T	2.13CA-12808T	2.13CA-12810T
Span in Feet	Allowable Superimposed Load In lbs/ft ²				
15	757				
16	663				
17	577	675			
18	505	612			
19	445	554	599		
20	393	512	547		
21	348	474	506	532	
22	310	432	466	487	528
23	276	388	431	454	490
24	246	349	404	418	454
25	220	315	373	392	422
26	197	284	352	364	395
27		257	327	343	368
28		233	305	340	346
29		212	279	319	324
30		192	255	303	304
31			233	282	289
32			213	269	270
33			195	253	258
34				236	243
35				217	228
36				200	219
37					208
38					196
39					187

Concrete Strength: 9,000 psi at 28 days
 Prestress Strands: 3/8", 7/16", 1/2" special, 270 ksi Lo-Lax
 Strands Stressed to 61%

*Limited by heat transmission requirements of ASTM E-119

 Camber 1"-1 1/2"
 Camber > 1 1/2"

Issued: 3/11/2019

©Spancrete www.spancrete.com



EX-120 Load Table

12" Thick

2.25" Strand Cover

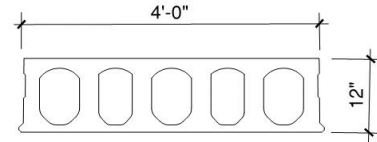

No Structural Topping					
Dead Load Weight of Slab = 90.5 psf					
IBC Fire Ratings	Unrestrained 3 hours				
	Restrained 3 hours*				
Section Properties					
A = 314 in ²	Yt = 5.932 in	b = 17.0 in			
I = 5262 in ⁴	Yb = 6.068 in	wt = 90.5 psf			
φM _n ft-k/ft	32.21	42.46	52.54	60.26	74.00
Series	2.25CA-12706	2.25CA-12708	2.25CA-12710	2.25CA-12808	2.25CA-12810
Span in Feet	Allowable Superimposed Load In lbs/ft ²				
15	648				
16	561				
17	489	667			
18	429	587			
19	378	520	614		
20	335	463	560		
21	297	413	519	546	
22	265	371	475	501	543
23	236	333	429	467	503
24	212	301	388	436	471
25	190	272	352	406	436
26	170	246	321	378	411
27	153	223	292	345	382
28	137	203	267	316	363
29		184	244	290	338
30		168	224	267	322
31		153	205	245	303
32		139	189	226	286
33		127	173	209	272
34			159	193	252
35			146	178	234
36			135	164	218
37				152	202
38				141	188
39				130	175
40					163
41					151
42					141
43					130

2" Bonded Structural Topping					
Dead Load Weight of Slab With Topping = 115.5 psf					
IBC Fire Ratings	Unrestrained 3 hours				
	Restrained 4 hours				
Section Properties					
A = 375 in ²	Yt = 6.85 in	b = 17.0 in			
I = 7637 in ⁴	Yb = 7.15 in	wt = 115.5 psf			
φM _n ft-k/ft	37.95	49.64	60.74	69.41	84.58
Series	2.25CA-12706T	2.25CA-12708T	2.25CA-12710T	2.25CA-12808T	2.25CA-12810T
Span in Feet	Allowable Superimposed Load In lbs/ft ²				
15	750				
16	654				
17	570	668			
18	499	608			
19	439	550	595		
20	388	507	541		
21	344	471	501	528	
22	305	426	463	482	524
23	272	382	427	449	485
24	243	344	401	417	453
25	217	310	369	388	418
26	194	280	349	363	393
27		254	323	339	364
28		230	301	318	345
29		208	274	300	321
30			251	280	303
31			229	268	286
32			210	250	268
33				232	257
34				213	240
35				197	227
36					219
37					205
38					194
39					187

Concrete Strength: 9,000 psi at 28 days
 Prestress Strands: 3/8", 7/16", 1/2" special, 270 ksi Lo-Lax
 Strands Stressed to 61%

*Limited by heat transmission requirements of ASTM E-119

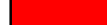
 Camber 1"-1 1/2"
 Camber > 1 1/2"

Issued: 3/11/2019
 ©Spancrete www.spancrete.com