

12'-0" x 42 1/2" Double Tees With Structural Topping

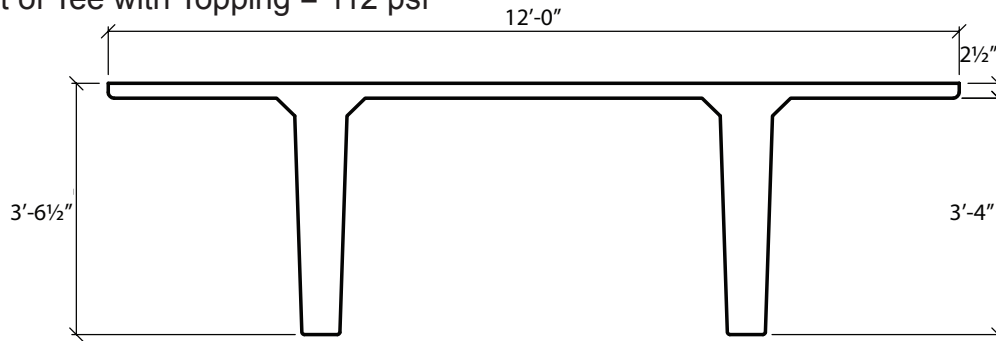

2 INCH MINIMUM AT MIDSPAN

Dead Load Weight of Tee with Topping = 112 psf



Section Properties	
A=1241 in. ²	Y _t =13.26 in.
I=221.132 in. ⁴	Y _b =31.24 in.

ØM _n ft-K	1773	2101	2409	2715	3001	3286	3551	3815
Strands	10-0.6"Ø	12-0.6"Ø	14-0.6"Ø	16-0.6"Ø	18-0.6"Ø	20-0.6"Ø	22-0.6"Ø	24-0.6"Ø
Span in Feet	Allowable Superimposed Load in Pounds Per Square Foot							
54	168	215						
56	150	194	235					
58	134	175	213					
60	120	158	194	229				
62	107	142	176	209	240			
64	95	128	160	191	220			
66	84	116	145	174	202	229		
68	75	104	132	160	185	211	224	
70	66	94	120	146	170	194	207	
72	57	84	108	133	156	178	190	
74	50	75	98	121	143	164	175	
76		66	89	111	131	150	161	172
78		59	80	101	120	138	149	158
80		52	72	92	110	127	137	146
82			64	83	101	116	126	135
84			57	75	92	106	115	124
86			51	68	84	97	106	114
88				61	76	88	97	105
90				54	69	80	89	96
92				48	63	73	81	88
94					56	66	74	81
96					50	59	67	74
98						53	60	67
100						47	54	61
102							49	55
104								50
106								44

Camber
 1"-2"
 ≥ 2"

Load Tables are presented as guidelines only. Design requirements must be reviewed by the engineer of record for each specific project.
 Spancrete | P.O. Box 828 | Waukesha, WI 53187 | 414-290-9000 | www.spancrete.com