

## 12'-0" x 24 1/2" Double Tees With Structural Topping

2 INCH MINIMUM AT MIDSPAN

Dead Load Weight of Tee with Topping = 83 psf

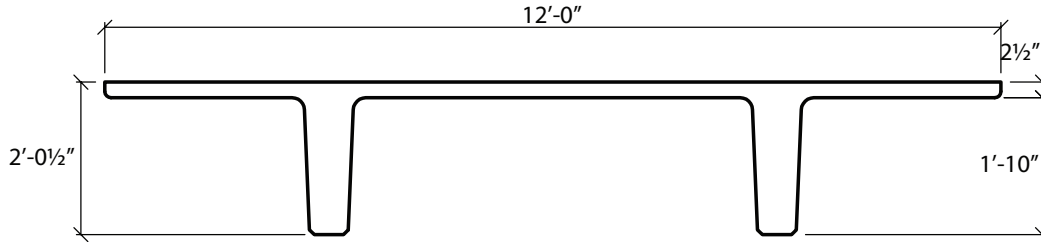

Section Properties	
A=907 in. <sup>2</sup>	Yt=6.71
I=46,294 in. <sup>4</sup>	Yb=19.79 in.

$\phi M_n$ ft-K	611	793	964	1125	1275	1414
Strands	6-0.6"Ø	8-0.6"Ø	10-0.6"Ø	12-0.6"Ø	14-0.6"Ø	16-0.6"Ø
Span in Feet	Allowable Superimposed Load in Pounds Per Square Foot					
30	220					
32	186					
34	158	223				
36	134	192	248			
38	114	166	216			
40	97	144	189			
42	82	125	165			
44	69	108	145			
46	58	94	127	157		
48	48	81	112	139		
50		70	98	122		
52		60	86	108		
54		51	75	95		
56		43	66	83	94	
58			57	72	83	
60			49	63	73	
62			42	54	64	
64				47	56	64
66				40	49	56
68					42	49
70						42

**Camber**

1"-2" (Grey)

≥ 2" (Red)