

12'-0" x 28 1/2" Double Tees With Structural Topping

2 INCH MINIMUM AT MIDSPAN

Dead Load Weight of Tee with Topping = 87 psf

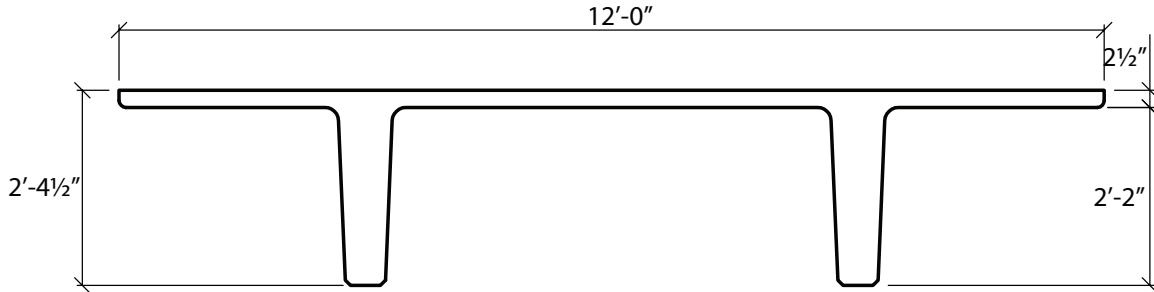

Section Properties	
A=955 in. ²	Yt=7.81 in.
I=67.959 in. ⁴	Yb=22.69 in.

ϕM_n ft-K	934	1140	1336	1521	1695	1858
Strands	8-0.6"Ø	10-0.6"Ø	12-0.6"Ø	14-0.6"Ø	16-0.6"Ø	18-0.6"Ø
Span in Feet	Allowable Superimposed Load in Pounds Per Square Foot					
36	235					
38	204					
40	178	231				
42	155	204				
44	135	180	222			
46	118	159	197			
48	103	141	176			
50	90	124	157			
52	78	110	140			
54	68	97	125			
56	58	86	112	129		
58	50	76	100	115		
60	42	66	89	103		
62		58	79	92		
64		50	70	82		
66		43	62	73	82	
68			54	64	73	
70			47	57	65	
72			40	50	58	65
74				43	51	58
76					45	51
78						45
80						40

Camber

1"-2" (Grey)

≥ 2" (Red)