

12'-0" x 42 1/2" Double Tees No Structural Topping

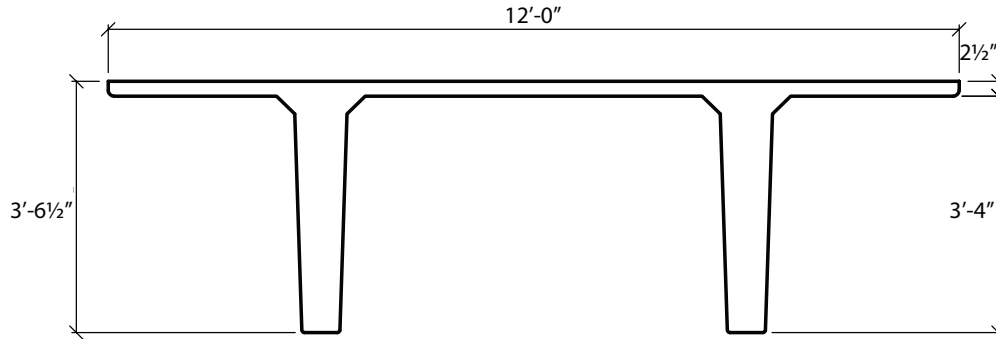

Dead Load Weight of Tee = 87 psf



Section Properties	
A=1006 in. ²	Yt=13.84 in.
I=177,569 in. ⁴	Yb=28.66 in.

ØM _n ft-K	1689	2002	2294	2586	2858	3128	3379	3629
Strands	10-0.6"Ø	12-0.6"Ø	14-0.6"Ø	16-0.6"Ø	18-0.6"Ø	20-0.6"Ø	22-0.6"Ø	24-0.6"Ø
Span in Feet	Allowable Superimposed Load in Pounds Per Square Foot							
62	117	151	182	214	243			
64	105	137	167	197	224	242		
66	95	125	153	181	207	224		
68	86	114	140	167	191	208	219	
70	77	104	129	153	177	192	203	
72	69	94	118	141	163	178	189	
74	62	86	108	130	151	166	176	
76	56	78	99	120	140	154	163	172
78	49	71	91	111	129	143	152	160
80	44	64	83	102	120	133	141	150
82		58	76	94	111	123	132	139
84		52	69	86	102	115	123	130
86		46	63	79	95	107	114	121
88		41	57	73	87	99	106	113
90			52	67	81	92	99	106
92			47	61	74	85	92	99
94			42	56	68	79	86	92
96				50	63	73	80	86
98				46	58	68	74	80
100				41	53	63	69	74
102					48	58	64	69
104					44	53	59	64
106						49	55	60
108						45	50	55
110							46	51
112							43	47
114								44

Camber
 1"-2"
 ≥ 2"

Load Tables are presented as guidelines only. Design requirements must be reviewed by the engineer of record for each specific project.
 Spancrete | P.O. Box 828 | Waukesha, WI 53187 | 414-290-9000 | www.spancrete.com