

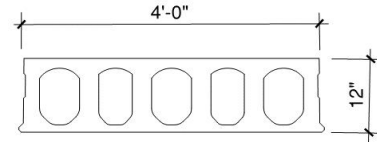

EX-120 Load Table

12" Thick

1.0" Strand Cover



No Structural Topping					
Dead Load Weight of Slab = 90.5 psf					
IBC Fire Ratings	Unrestrained 1 hours				
	Restrained 3 hours*				
Section Properties					
A = 314 in ²	Yt = 5.932 in	b = 17.0 in			
I = 5262 in ⁴	Yb = 6.068 in	wt = 90.5 psf			
ϕM_n ft-k/ft	36.58	48.29	59.75	68.72	84.61
Series	1.0CA-12706	1.0CA-12708	1.0CA-12710	1.0CA-12808	1.0CA-12810
Span in Feet	Allowable Superimposed Load In lbs/ft ²				
18	496				
19	439	601			
20	389	536			
21	347	479	583		
22	310	431	545	569	
23	278	388	497	525	
24	249	351	451	494	
25	225	318	410	457	
26	202	289	374	434	462
27	183	263	342	403	434
28	165	240	313	370	409
29	149	219	287	341	384
30	135	200	264	314	366
31	122	183	243	290	344
32	111	168	224	268	329
33	100	154	206	248	308
34	90	141	190	229	286
35		129	176	212	266
36		118	162	197	247
37		108	150	183	230
38		99	139	170	214
39		91	128	158	200
40			119	147	186
41			110	136	174
42			101	127	162
43			94	118	152
44				109	141
45				102	132
46				94	123
47					115
48					107
49					100
50					93

2" Bonded Structural Topping					
Dead Load Weight of Slab With Topping = 115.5 psf					
IBC Fire Ratings	Unrestrained 1 hours				
	Restrained 4 hours				
Section Properties					
A = 375 in ²	Yt = 6.85 in	b = 17.0 in			
I = 7637 in ⁴	Yb = 7.15 in	wt = 115.5 psf			
ϕM_n ft-k/ft	42.32	55.46	68.02	77.86	95.17
Series	1.0CA-12706T	1.0CA-12708T	1.0CA-12710T	1.0CA-12808T	1.0CA-12810T
Span in Feet	Allowable Superimposed Load In lbs/ft ²				
18	566				
19	499	628			
20	442	571			
21	393	531	565		
22	350	486	527	550	
23	313	437	485	507	
24	281	395	455	477	
25	252	357	423	440	
26	226	323	398	417	444
27	203	294	371	386	415
28	183	267	347	367	392
29	165	243	318	343	365
30	148	221	291	324	349
31		202	267	309	327
32		184	245	289	310
33		168	226	271	295
34		153	207	250	277
35			191	231	265
36			176	214	254
37			162	198	239
38			149	183	228
39				169	218
40				157	201
41				145	186
42					172
43					158
44					146
45					134

Concrete Strength: 9,000 psi at 28 days
 Prestress Strands: 3/8", 7/16", 1/2" special, 270 ksi Lo-Lax
 Strands Stressed to 61%

*Limited by heat transmission requirements of ASTM E-119

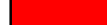
 Camber 1"-1 1/2"
 Camber > 1 1/2"

Issued: 3/11/2019
 ©Spancrete www.spancrete.com



EX-120 Load Table

12" Thick

1.63" Strand Cover

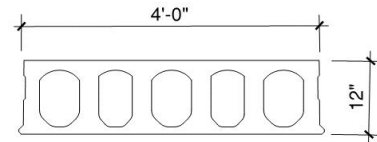

No Structural Topping					
Dead Load Weight of Slab = 90.5 psf					
IBC Fire Ratings	Unrestrained 2 hours				
	Restrained 3 hours*				
Section Properties					
A = 314 in ²	Yt = 5.932 in	b = 17.0 in			
I = 5262 in ⁴	Yb = 6.068 in	wt = 90.5 psf			
ϕM_n ft-k/ft	34.38	45.35	56.16	64.46	79.26
Series	1.63CA-12706	1.63CA-12708	1.63CA-12710	1.63CA-12808	1.63CA-12810
Span in Feet	Allowable Superimposed Load In lbs/ft ²				
15	696				
16	603				
17	527	717			
18	462	632			
19	408	560	653		
20	362	499	594		
21	322	446	551	579	
22	287	400	512	531	
23	257	361	463	496	533
24	230	326	419	463	500
25	207	295	381	431	462
26	186	267	347	407	437
27	168	243	317	374	406
28	151	221	290	343	386
29	136	202	266	315	360
30	123	184	244	290	343
31	111	168	224	267	324
32		153	206	247	305
33		140	190	228	293
34		128	175	211	272
35		117	161	195	252
36		107	149	181	234
37			137	167	218
38			126	155	202
39			117	144	188
40			107	133	175
41				124	163
42				115	152
43				106	141
44					132
45					122
46					114
47					106

2" Bonded Structural Topping					
Dead Load Weight of Slab With Topping = 115.5 psf					
IBC Fire Ratings	Unrestrained 2 hours				
	Restrained 4 hours				
Section Properties					
A = 375 in ²	Yt = 6.85 in	b = 17.0 in			
I = 7637 in ⁴	Yb = 7.15 in	wt = 115.5 psf			
ϕM_n ft-k/ft	40.12	52.53	64.35	73.60	89.83
Series	1.63CA-12706T	1.63CA-12708T	1.63CA-12710T	1.63CA-12808T	1.63CA-12810T
Span in Feet	Allowable Superimposed Load In lbs/ft ²				
15	795				
16	697				
17	607	709			
18	532	647			
19	469	586	634		
20	415	538	576		
21	368	501	533	561	
22	328	456	495	513	
23	292	410	455	478	516
24	261	369	428	444	482
25	234	333	394	414	445
26	210	302	374	388	419
27	188	273	346	363	388
28	169	248	324	340	369
29	152	226	296	322	343
30		205	271	300	324
31		187	248	287	306
32		170	227	269	287
33			209	251	275
34			192	232	259
35			176	214	244
36			162	197	235
37				182	222
38				168	209
39					202
40					187
41					172
42					158

Concrete Strength: 9,000 psi at 28 days
 Prestress Strands: 3/8", 7/16", 1/2" special, 270 ksi Lo-Lax
 Strands Stressed to 61%

*Limited by heat transmission requirements of ASTM E-119

 Camber 1"-1 1/2"
 Camber > 1 1/2"

Issued: 3/11/2019

©Spancrete www.spancrete.com



EX-120 Load Table

12" Thick

2.13" Strand Cover

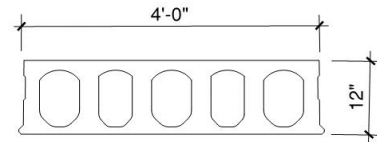



No Structural Topping					
Dead Load Weight of Slab = 90.5 psf					
IBC Fire Ratings	Unrestrained 3 hours				
	Restrained 3 hours*				
Section Properties					
A = 314 in ²	Yt = 5.932 in	b = 17.0 in			
I = 5262 in ⁴	Yb = 6.068 in	wt = 90.5 psf			
ϕM_n ft-k/ft	32.63	43.02	56.16	64.46	75.02
Series	2.13CA-12706	2.13CA-12708	2.13CA-12710	2.13CA-12808	2.13CA-12810
Span in Feet	Allowable Superimposed Load In lbs/ft ²				
15	657				
16	569				
17	496	676			
18	435	596			
19	384	528	618		
20	340	470	565		
21	302	420	524	550	
22	269	376	482	504	545
23	240	339	435	472	508
24	215	305	394	437	473
25	193	276	358	410	440
26	173	250	326	383	414
27	156	227	297	351	385
28	140	206	272	321	365
29	126	188	248	295	342
30	113	171	228	271	323
31		156	209	250	306
32		142	192	230	287
33		129	176	212	276
34		118	162	196	257
35			149	181	238
36			137	168	221
37			126	155	206
38			116	143	192
39				133	178
40				123	166
41					154
42					143
43					133
44					123

2" Bonded Structural Topping					
Dead Load Weight of Slab With Topping = 115.5 psf					
IBC Fire Ratings	Unrestrained 3 hours				
	Restrained 4 hours				
Section Properties					
A = 375 in ²	Yt = 6.85 in	b = 17.0 in			
I = 7637 in ⁴	Yb = 7.15 in	wt = 115.5 psf			
ϕM_n ft-k/ft	38.37	50.20	61.44	70.22	85.59
Series	2.13CA-12706T	2.13CA-12708T	2.13CA-12710T	2.13CA-12808T	2.13CA-12810T
Span in Feet	Allowable Superimposed Load In lbs/ft ²				
15	757				
16	663				
17	577	675			
18	505	612			
19	445	554	599		
20	393	512	547		
21	348	474	506	532	
22	310	432	466	487	528
23	276	388	431	454	490
24	246	349	404	418	454
25	220	315	373	392	422
26	197	284	352	364	395
27		257	327	343	368
28		233	305	340	346
29		212	279	319	324
30		192	255	303	304
31			233	282	289
32			213	269	270
33			195	253	258
34				236	243
35				217	228
36				200	219
37					208
38					196
39					187
40					
41					
42					
43					
44					

Concrete Strength: 9,000 psi at 28 days
 Prestress Strands: 3/8", 7/16", 1/2" special, 270 ksi Lo-Lax
 Strands Stressed to 61%

*Limited by heat transmission requirements of ASTM E-119

 Camber 1"-1 1/2"
 Camber > 1 1/2"

Issued: 3/11/2019

©Spancrete www.spancrete.com



EX-120 Load Table

12" Thick

2.25" Strand Cover

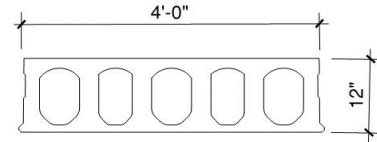

No Structural Topping					
Dead Load Weight of Slab = 90.5 psf					
IBC Fire Ratings	Unrestrained 3 hours				
	Restrained 3 hours*				
Section Properties					
A = 314 in ²	Yt = 5.932 in	b = 17.0 in			
I = 5262 in ⁴	Yb = 6.068 in	wt = 90.5 psf			
ϕM_n ft-k/ft	32.21	42.46	52.54	60.26	74.00
Series	2.25CA-12706	2.25CA-12708	2.25CA-12710	2.25CA-12808	2.25CA-12810
Span in Feet	Allowable Superimposed Load In lbs/ft ²				
15	648				
16	561				
17	489	667			
18	429	587			
19	378	520	614		
20	335	463	560		
21	297	413	519	546	
22	265	371	475	501	543
23	236	333	429	467	503
24	212	301	388	436	471
25	190	272	352	406	436
26	170	246	321	378	411
27	153	223	292	345	382
28	137	203	267	316	363
29		184	244	290	338
30		168	224	267	322
31		153	205	245	303
32		139	189	226	286
33		127	173	209	272
34			159	193	252
35			146	178	234
36			135	164	218
37				152	202
38				141	188
39				130	175
40					163
41					151
42					141
43					130

2" Bonded Structural Topping					
Dead Load Weight of Slab With Topping = 115.5 psf					
IBC Fire Ratings	Unrestrained 3 hours				
	Restrained 4 hours				
Section Properties					
A = 375 in ²	Yt = 6.85 in	b = 17.0 in			
I = 7637 in ⁴	Yb = 7.15 in	wt = 115.5 psf			
ϕM_n ft-k/ft	37.95	49.64	60.74	69.41	84.58
Series	2.25CA-12706T	2.25CA-12708T	2.25CA-12710T	2.25CA-12808T	2.25CA-12810T
Span in Feet	Allowable Superimposed Load In lbs/ft ²				
15	750				
16	654				
17	570	668			
18	499	608			
19	439	550	595		
20	388	507	541		
21	344	471	501	528	
22	305	426	463	482	524
23	272	382	427	449	485
24	243	344	401	417	453
25	217	310	369	388	418
26	194	280	349	363	393
27		254	323	339	364
28		230	301	318	345
29		208	274	300	321
30			251	280	303
31			229	268	286
32			210	250	268
33				232	257
34				213	240
35				197	227
36					219
37					205
38					194
39					187

Concrete Strength: 9,000 psi at 28 days
 Prestress Strands: 3/8", 7/16", 1/2" special, 270 ksi Lo-Lax
 Strands Stressed to 61%

*Limited by heat transmission requirements of ASTM E-119

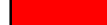
 Camber 1"-1 1/2"
 Camber > 1 1/2"

Issued: 3/11/2019
 ©Spancrete www.spancrete.com